

# MM8301\*\*E CHAUMONT LED ILLUMINATED MIRROR 900 X 600 X 55MM

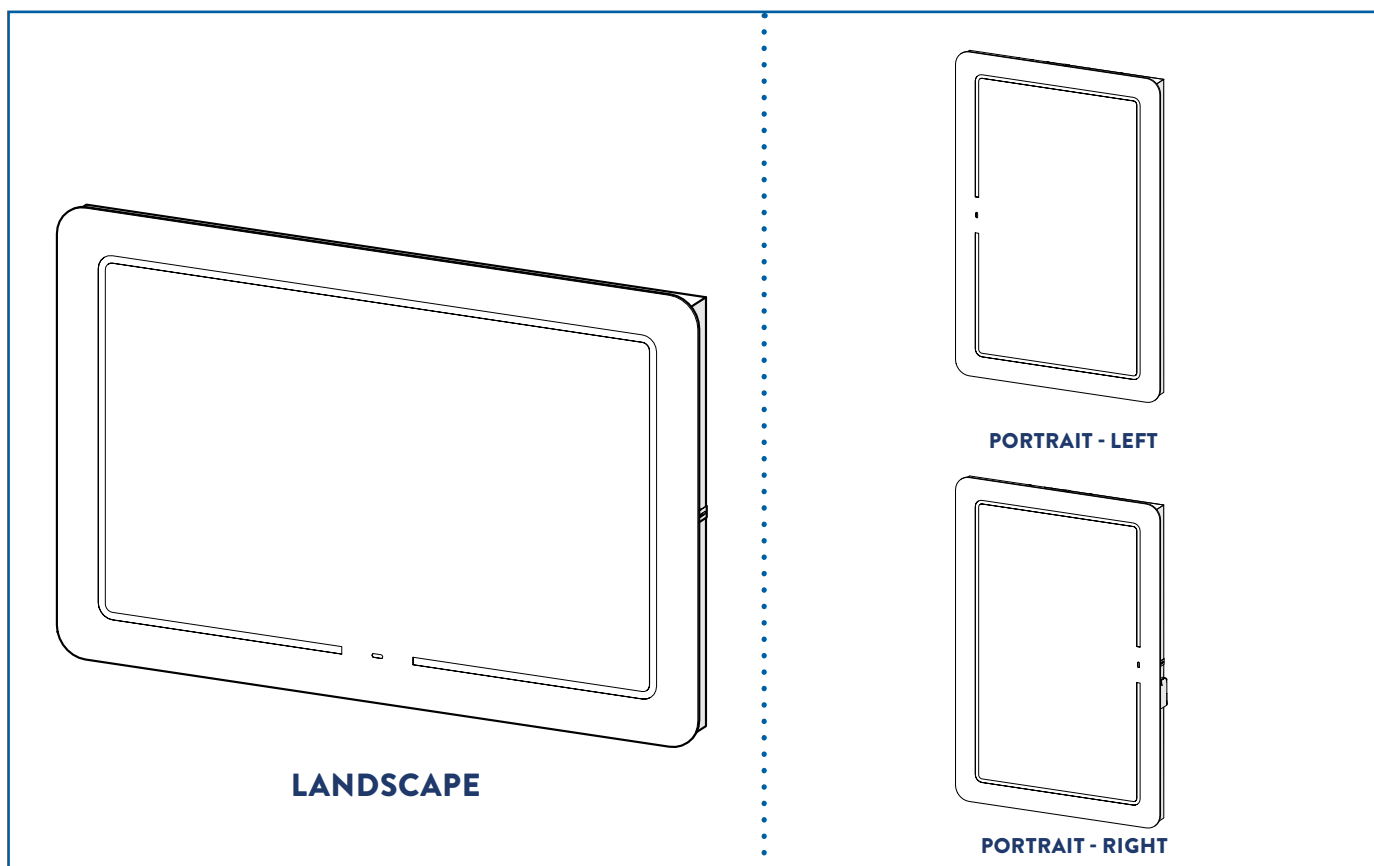

**ALL ILLUSTRATIONS OF THE PRODUCT ARE FOR REFERENCE ONLY. COMPONENTS SUPPLIED WITH INDIVIDUAL PRODUCTS MAY DIFFER**

**ALL PRODUCT DIMENSIONS DETAILED IN THIS INSTALLATION AND MAINTENANCE MANUAL ARE APPROXIMATE**

## **CONTACT DETAILS (UK)**

Croydex  
Central Way  
Andover  
Hampshire  
SP10 5AW  
UK

Tel: +44 (0)1264 365881  
Email: [info@croydex.co.uk](mailto:info@croydex.co.uk)

Web: [www.croydex.com](http://www.croydex.com)

## **CONTACT DETAILS (EU)**

MIL  
Unit 8 Purcellsinch Ind Est  
Dublin Road  
Kilkenny  
R95 HP71  
Ireland



**ALWAYS CHECK THE PACKAGING FOR FIXINGS AND PARTS BEFORE RECYCLING OR DISPOSAL.**

**PLEASE READ THROUGH AND FULLY UNDERSTAND THE INSTRUCTION LEAFLET BEFORE STARTING THE INSTALLATION OF THIS MIRROR.**

**ENSURE YOU HAVE ALL THE FIXINGS AND PARTS BEFORE ATTEMPTING TO ASSEMBLE OR FIT THIS PRODUCT.**

# SECTION 1 - INTRODUCTION

Thank you for purchasing this Croydex product. Please follow the fixing and care instructions to ensure that your product is fitted safely and that it retains its high quality finish. **PLEASE RETAIN THIS MANUAL FOR FUTURE REFERENCE.**

## SAFETY & PRODUCT CARE

1. **ALWAYS** take care when using power tools, particularly if there is any water in the working area.
2. **ALWAYS** wear eye protection when using power tools.
3. **ALWAYS** check for pipes and cables before drilling into walls.
4. **ALWAYS** use a ceramic drill bit when drilling into tiled surfaces.
5. **ALWAYS** use a drill bit that is suitable for the surface that is being drilled.
6. The wall plugs supplied are for use on solid walls only. For cavity walls or plasterboard **ALWAYS** use specialist fixings that are suitable for the type of wall construction.
7. **DO NOT** use abrasive or chemical cleaners as these may damage the product.
8. **DO NOT** strike the mirror with hard or sharp objects.
9. **DO NOT** drill on the grout line of tiles.
10. **ALWAYS** use masking tape on tiles surfaces.

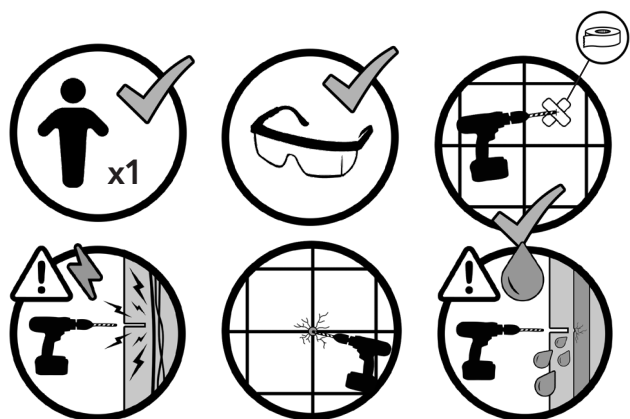

## IMPORTANT INSTALLATION INFORMATION

This is a class 1 appliance and **MUST** be connected to earth.

Hazardous voltages inside - **DO NOT** remove any covers.

This product **MUST ONLY** be installed in accordance with the installation instructions.

Connection of the electrical supply **MUST ONLY** be carried out by a competent person in accordance with the Building Regulations 2010 and connection to the fixed wiring of the mains electrical supply must comply with the current revision of the IET Wiring Regulations BS 7671.

Keep DIY tools out of the reach of children.

**Electrical Supply:** 220-240Vac 50Hz 56W

**Shaver Socket:** 220-240Vac 20VA Max

**Demister Pad:** 220-240Vac 10W

**Lamp Type:** LED 12Vdc 26W 193lm 4000K

**Ingress Protection:** IP44

## TOOLS REQUIRED (not supplied)

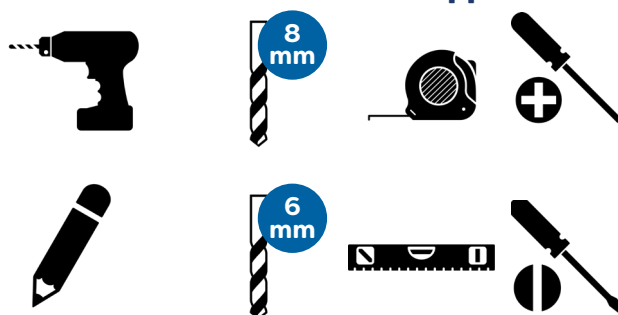

## WALL FIXING PACK

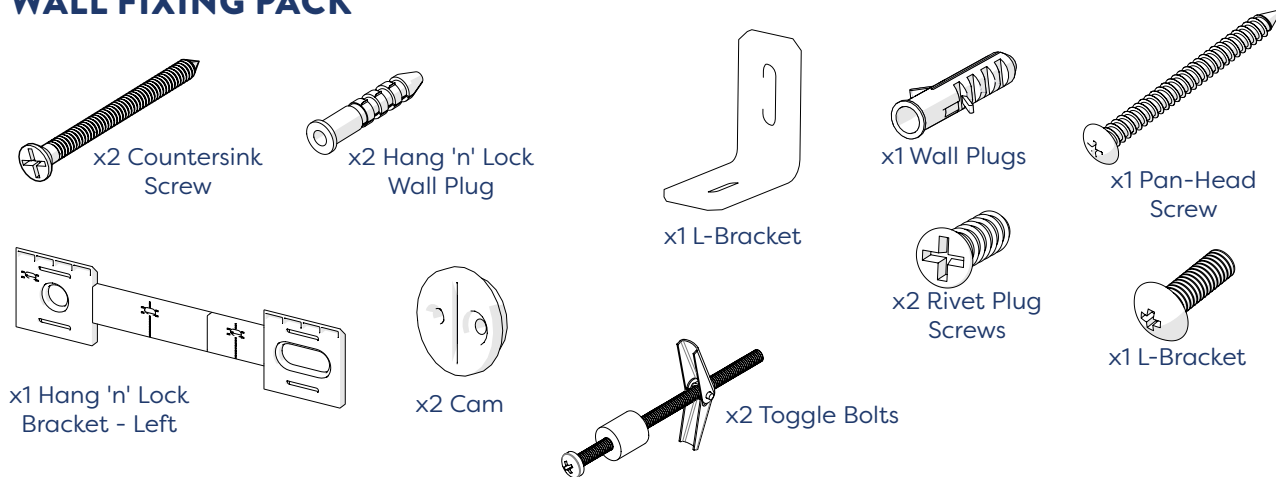

## IMPORTANT WARRANTY INFORMATION

In some circumstances the Building Regulations 2010 require the installer to give the occupier of the premises in which this product has been installed a certificate to confirm that the requirements of regulations 4 and 7 have been satisfied, or the installation of this product must be inspected and tested by the Local Authority Building Control Department who will issue a compliance certificate.

A copy of this certificate may be required for certain warranty claims. Failure to provide a copy of the certificate may invalidate the warranty. This does not affect your statutory rights.

We recommend that you make yourself aware of the Regulations before you undertake any work and if you require clarification you should contact your Local Authority Building Control Department.

## POSITIONING THE MIRROR

1. The mirror is rated IP44 and must only be installed with the connection to the domestic mains electrical supply in the Outside Zones, as shown in **Fig. 1**.
2. Ensure that the access to the domestic mains electrical supply is located behind the intended mounting position for the mirror and unobstructed by the mounting brackets.

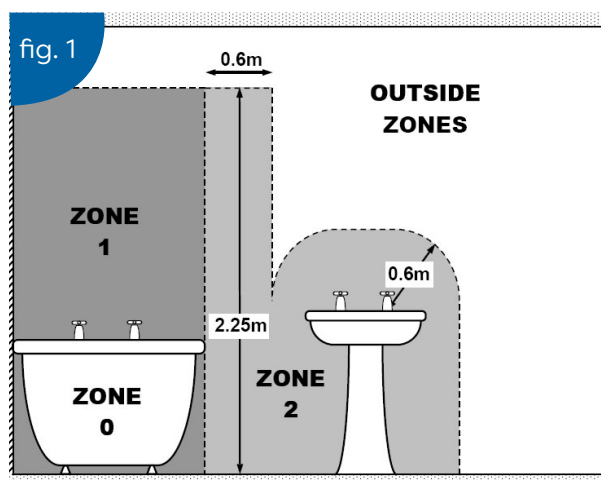

## SECTION 2 - MOUNTING USING HANG 'N' LOCK

1. Assemble the Hang 'n' Lock bracket sections making sure all parts are slotted tightly together.  
(See Fig. 2)

**Note: The Hang 'n' Lock bracket may vary in size.**

fig. 2

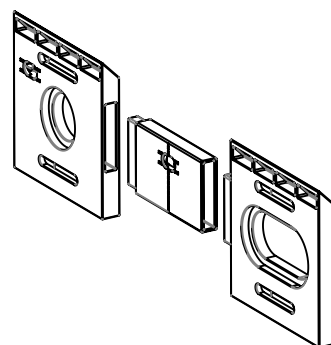

2. Place the Hang 'n' Lock bracket onto the support slot on the back of the mirror. Make a note of the distance from the bottom edge of the bracket to the top edge of the mirror - this will help you when mounting your mirror.  
(See Fig. 3)

**Note: The mirror can be hung in both portrait and landscape. Ensure your mirror is correctly orientated before positioning.**

fig. 3

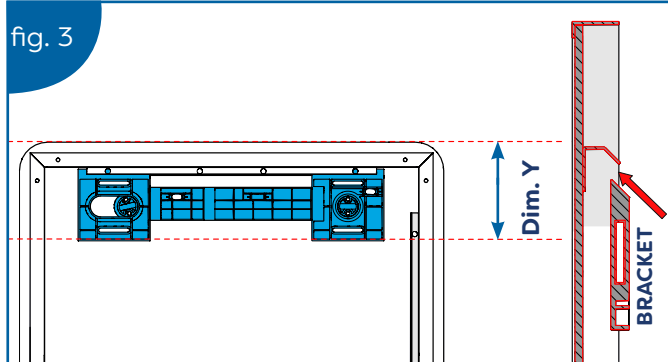

3. Carefully hold your mirror in the desired location on the wall. Using a pencil, draw a reference line along the top edge of the mirror. Use the bracket distance you measured earlier to create a reference line where the bottom of your Hang 'n' Lock bracket will be.  
(See Fig. 4)

(See Fig. 4)

fig. 4

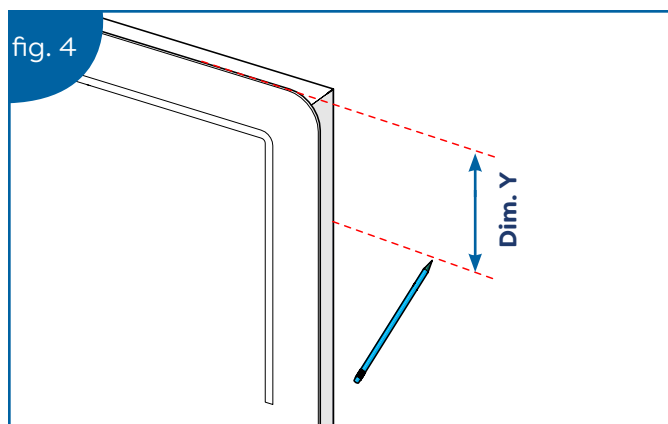

4. Place the bottom edge of the Hang 'n' Lock bracket onto the lower reference line. Mark the hole centres with a pencil.  
(See Fig. 5)

(See Fig. 5)

**Note: Check the cams are oriented correctly with the countersink holes positioned at the top.**

fig. 5

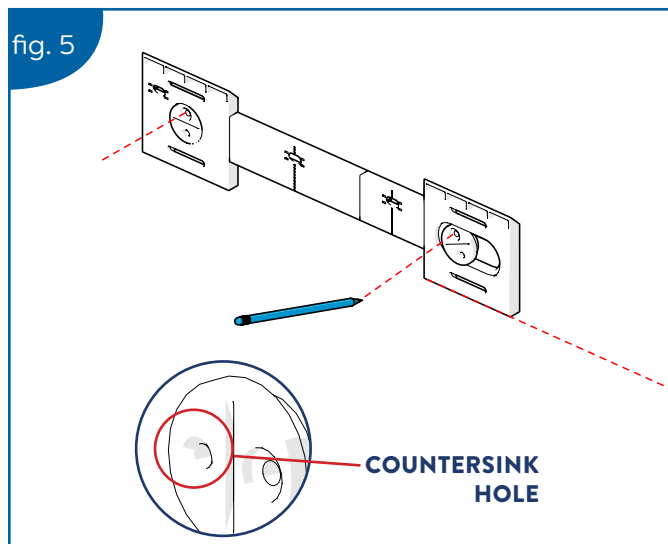

5. Drill the marked holes to a depth of 45mm. Insert the wall plugs level with the surface of the wall. **If you are fitting to a tiled surface, insert the wall plugs below the surface of the tile to avoid cracking the tiles. Wall plugs supplied are for use on solid walls only. (See Fig. 6)**

**NOTE:**

For **CAVITY WALLS** or **PLASTERBOARD** use toggle bolts provided. See **SECTION 5 - Toggle Bolt Installation**. Continue to Step 7.

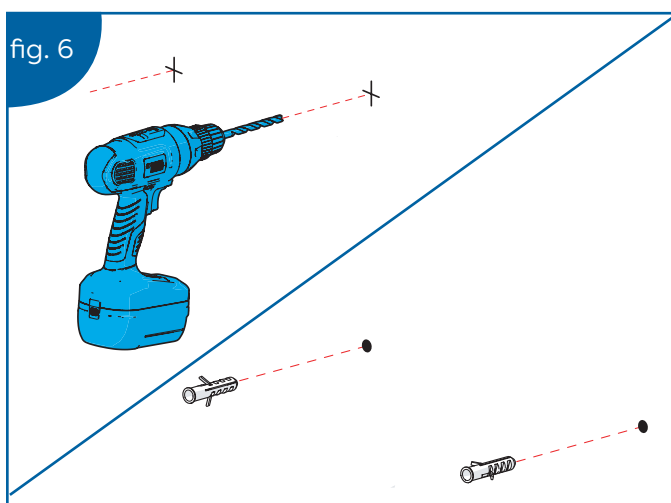

6. Insert the countersink screws through the Hang 'n' Lock cams and loosely secure the Hang 'n' Lock bracket to the wall.

(See Fig. 7)

**Note: Check the cams are oriented correctly with the countersink holes positioned at the top.**

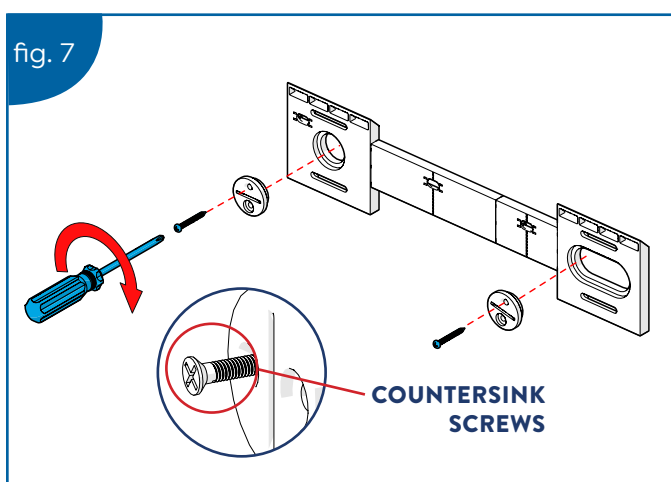

7. With the Hang 'n' Lock bracket loosely attached to the wall, adjust for height and level by rotating the cams with a flat head screwdriver. Use the attached spirit level as a guide. Once complete, fully tighten the mounting screws to securely fix the bracket into position.

(See Fig. 8)

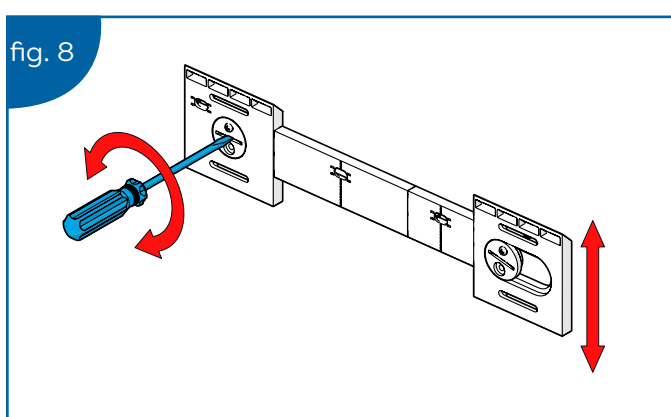

8. Hang the mirror onto the Hang 'n' Lock bracket. Ensure the mirror has securely located onto the bracket before letting go.

(See Fig. 9)

**Note: If the mirror is not vertical, remove the mirror, loosen bracket screws and repeat Step 6.**

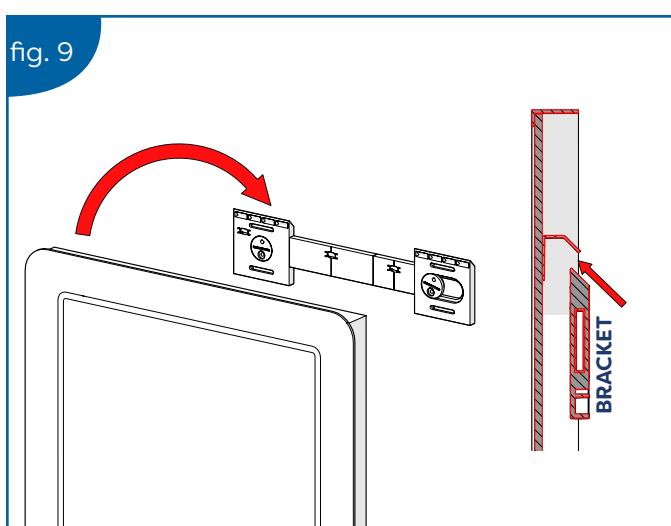

**Note: The position of the mirror can be adjusted by sliding left or right along the bracket.**

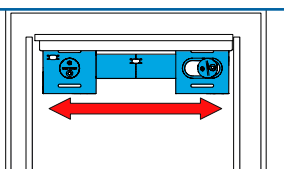

9. Place the L bracket over the threaded rivet located at the bottom of the mirror. Using a pencil mark the position of the L bracket onto the wall.

(See Fig. 10)

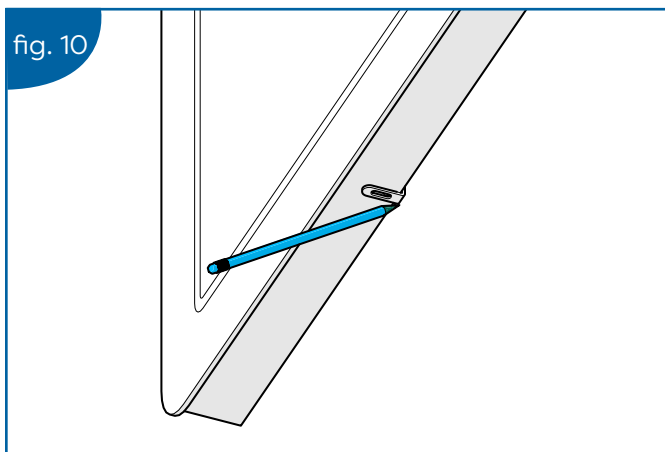

10. Gently remove the mirror, place the L bracket on the mark and drill a hole in the centre of the slot on the wall. Insert the wall plug and lightly screw the bracket to the wall, allowing the bracket to be moved up and down the slot.

(See Fig. 11)

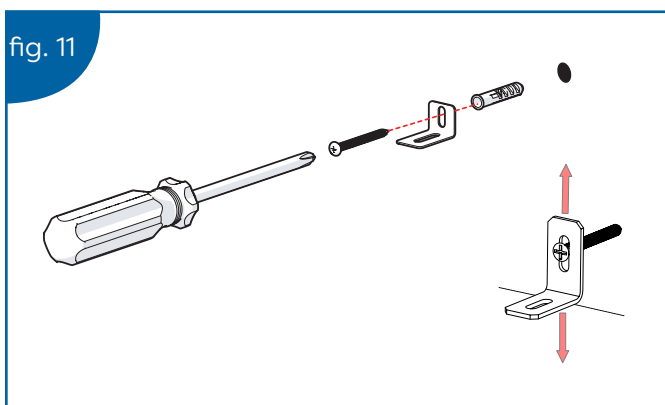

**\* Refer to SECTION 6 - CONNECTING THE ELECTRICAL SUPPLY before proceeding to step 11 and fastening the mirror. \***

11. With the mirror in place, secure the L bracket to the mirror using the bolt provided. (See Fig. 12)

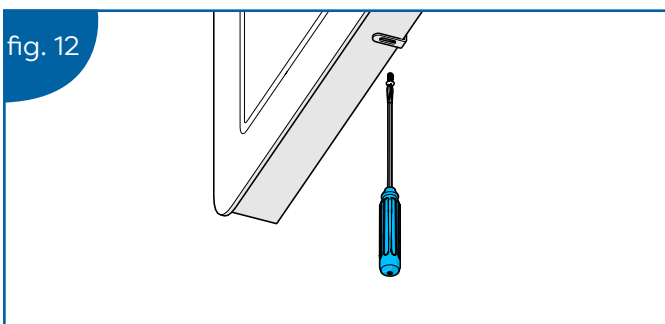

## SECTION 3 - SIDE RIVET COVER

**NOTE:** To conceal the L-bracket rivet plug screw(s) that are not used, a screw can be inserted to cover the exposed hole.

(See Fig. 13)

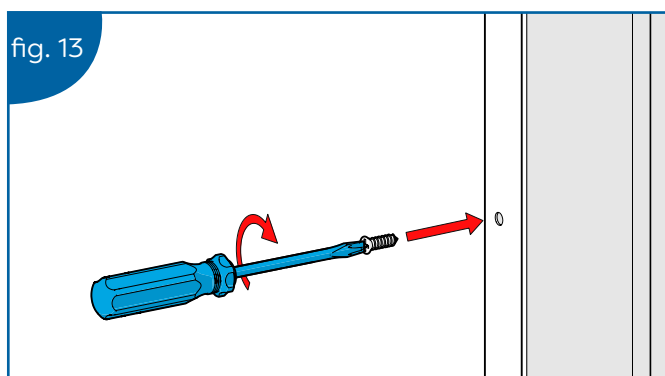

## SECTION 4 - SHAVER SUPPLY UNIT

**NOTE:** The shaver supply unit is suitable for use with electric razors, toothbrushes and similar low power appliances only.

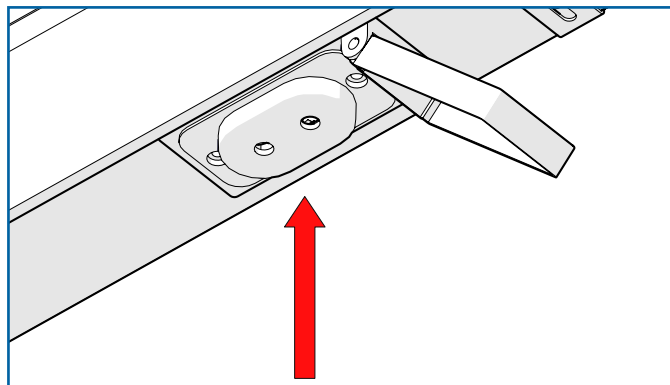
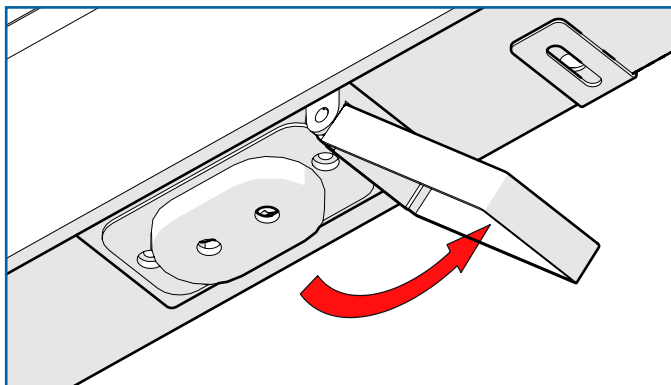

**Operation:** Flip open socket cover and plug in desired device.

## SECTION 5 - TOGGLE BOLT INSTALLATION

### TOGGLE BOLT INSTALLATION

During **Step 5 & 6**, if toggle bolts are used, follow the steps below:

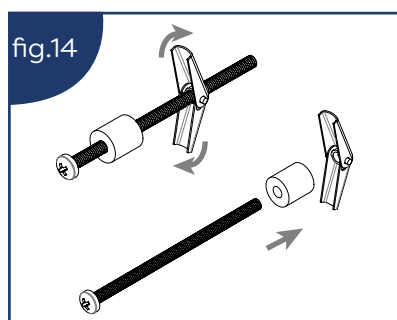

i) Drill marked holes with an 11mm drill bit.

ii) Dismantle the toggle bolt. **(See Fig. 14)**

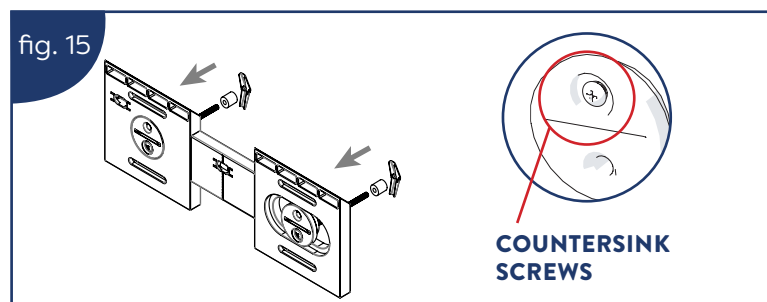

iii) Insert the threaded bolt through the Hang 'n' Lock cams and reattach the plugs and spring.

**(See Fig. 15)**

**Note:** Ensure the screws go through the holes with the counter-bore holes.

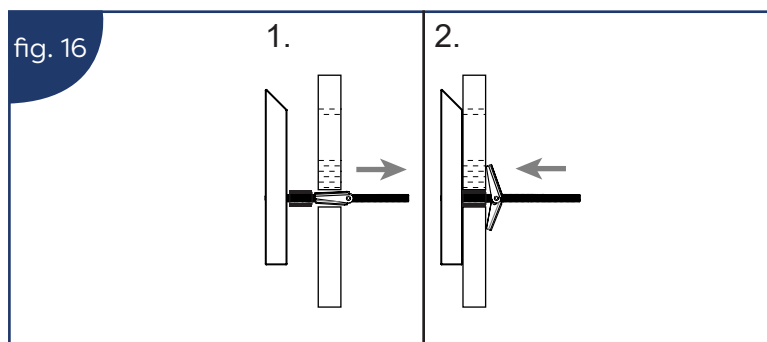

iv) Push the spring loaded wall braces on the toggle bolts through the drilled holes and loosely secure the Hang 'n' Lock bracket to the wall. **(See Fig. 16)**

**\*Continue from STEP 7 on the main instruction leaflet\***

## SECTION 6 - CONNECTING THE ELECTRICAL SUPPLY

REMOVE THE MIRROR FROM THE WALL.

**ENSURE THAT THE DOMESTIC ELECTRICAL MAINS SUPPLY TO WHICH THE MIRROR IS TO BE CONNECTED IS TURNED OFF.**

Connect the flexible mains supply cable on the mirror to the domestic electrical mains supply ensuring that:

- The Live (Brown) conductor is connected to the Live on the domestic electrical mains supply.
- The Neutral (Blue) conductor is connected to the Neutral on the domestic electrical mains supply.
- The Earth (Green/Yellow) conductor is connected to the Earth/Ground on the domestic electrical mains supply.

**Note: Connection of the electrical supply MUST ONLY be carried out by a competent person in accordance with the Building Regulations 2010 and connection to the fixed wiring of the mains electrical supply must comply with the current revision of the IET Wiring Regulations BS 7671.**

Hang the mirror and secure using the **L bracket (SECTION 2 - Step 11)**. Turn the electrical mains supply back on.

## SECTION 7 - OPERATING THE MIRROR

**FOLLOW THESE INSTRUCTIONS TO OPERATE THE MIRROR**

**FROM OFF:**

1. Single **WAVE** to turn **ON** light and activate anti-fog function.
2. Single **WAVE** to turn **OFF**.

Colour temperature: **4000K**



# SECTION 8 - TECHNICAL INFORMATION

## PRODUCT REPAIR

In the unlikely event that your shaver unit or LED lighting becomes faulty, they can be replaced by a qualified electrician. Detailed repair instructions (REP00009.pdf) can be downloaded from [www.croydex.com](http://www.croydex.com) or requested from [info@croydex.co.uk](mailto:info@croydex.co.uk)

## PRODUCT RECYCLING

This product has been designed so that electrical components can be easily removed by the consumer for recycling at end of life. A detailed Electronic and Electrical Waste Recycling Guide (WEEE00009.pdf) can be downloaded from [www.croydex.com](http://www.croydex.com)



THIS PRODUCT COMPLIES WITH THE REQUIREMENTS OF:

The UK Electrical Equipment (Safety) Regulations 2016

The UK Electromagnetic Compatibility Regulations 2016

The UK Restriction of the Use of Certain Hazardous Substances in Electrical and Electronic Equipment Regulations 2012

The EU Low Voltage Directive (LVD) 2014/35/EU

The EU Electromagnetic Compatibility (EMC) Directive 2014/30/EU

The EU Restriction of Hazardous Substances (RoHS) Directive 2011/65/EU

The following UKCA and CE Declarations of Conformity can be downloaded from [www.croydex.com](http://www.croydex.com) or requested from [info@croydex.co.uk](mailto:info@croydex.co.uk):

UKCA electrical safety and EMC (UKCA-DoC-00001-Safety-EMC.pdf)

UKCA RoHS (UKCA-DoC-00001-RoHS.pdf)

EU CE LVD and EMC (CE-DoC-00001-LVD-EMC.pdf)

EU CE RoHS (CE-DoC-00001-RoHS.pdf)

UK: Croydex, Central Way, Andover, Hampshire, SP10 5AW, UK.

EU: MIL, Unit 8 Purcellsinch Ind Est, Dublin Road, Kilkenny, R95 HP71, Ireland

Web: [www.croydex.com](http://www.croydex.com)